

UCHIDA

# ASISTA

SIMPLE TABLE SYSTEM







## Evolutional Conjunction Table System

ASISTA is a table sufficiently equipped with necessary functions, such as large wiring space & desktop panel. With variation of single-sided and double-sided type, supporting with different kinds of connection, it demonstrates its superior scalability. From work scene to meeting scene, a simple table system which supports different kinds of scenes, that is ASISTA.

## WIRING SYSTEM

### 1 Grommet



Adopt rectangular flip top grommets with brush strips. It is an easy-to-use structure for opening & closing the grommets.

### 2 Wiring Space



Equipped with large wiring space.

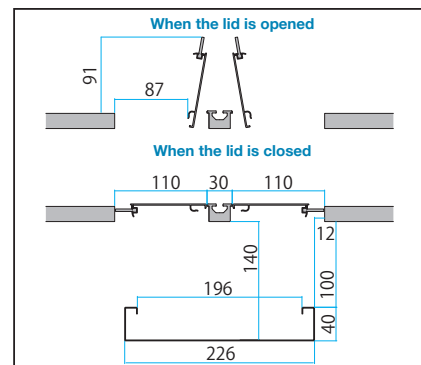

Wiring space (both side)

## WIRING SYSTEM

### 3 Shared Leg



#### Shared Leg for Vertical Wiring

The Shared Leg has enough space for vertical wiring to make best use of large wiring tray.

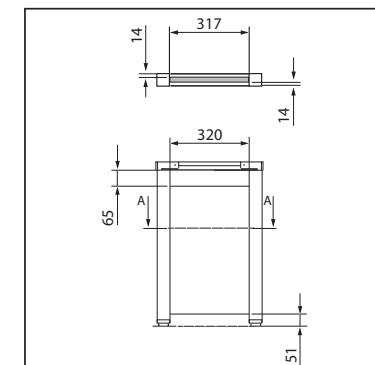

### 4 Wiring Tray & Wiring Guide



Wiring guide attached on wiring tray.



COLOR OPTION FOR TABLE TOP

OPTION

We have two color options, White and Maple.



DESKTOP PANEL

OTHER OPTION



Panel fabric colors

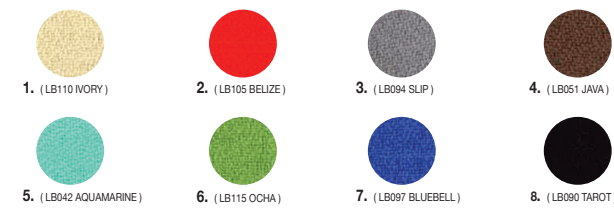

Clamp type units, or task light can be attached.



Side Modesty Panel can be attached.

ACCESSORIES FOR DESKTOP

OPTION



Multi-accessories Tray



Hanging Metal white board

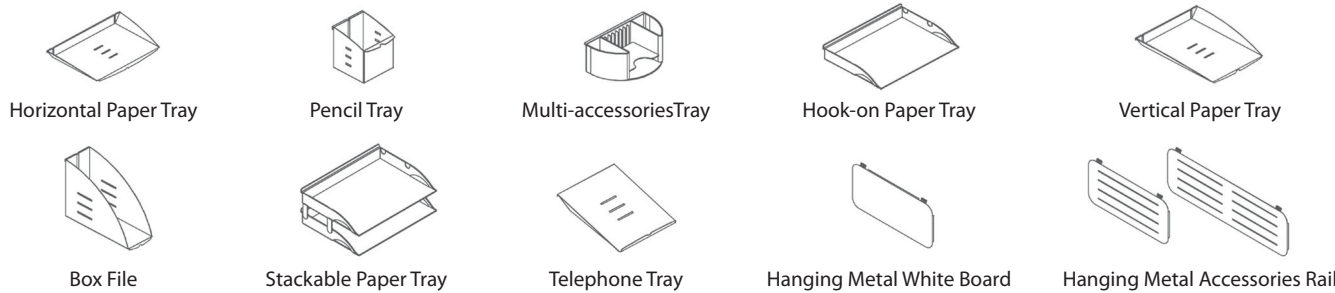

DRAWER

OPTION



LMP-2SP

LMP-2AH

**LMP-2SP**

2 Box + 1 File + 5th Castor  
H610 W420 D500 GW: 20KG

**LMP-2AH**

2 Box + 1 File + 5th Castor  
H610 W420 D500 GW: 20.5KG

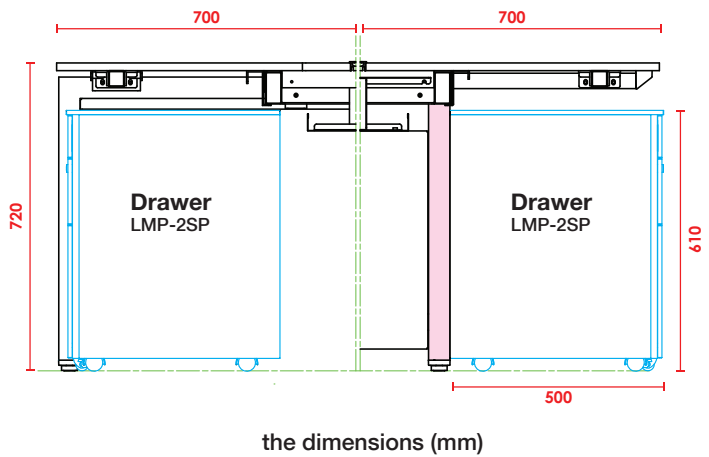

the dimensions (mm)

**Leg and Drawer**

Shared Leg is good enough to support the table top and also provide enough space for legs and drawer.

LEG STRUCTURE

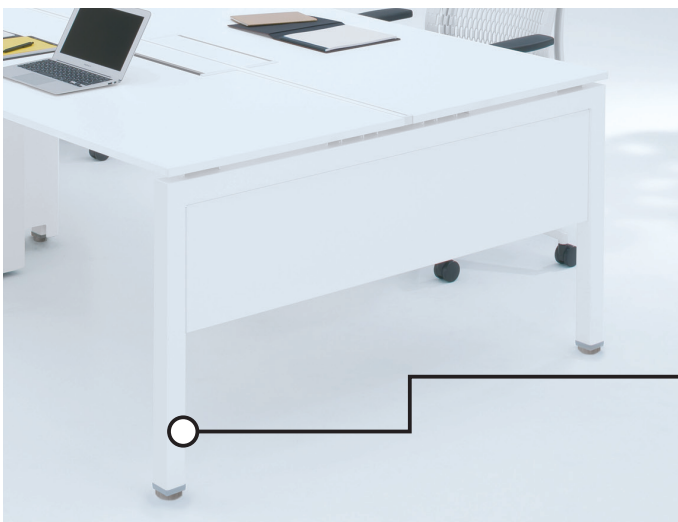

**Leg Structure**

Double Structure Legs improve the strength, and surely prevent shaking of whole table.

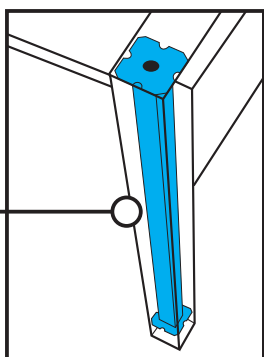

PLATFORM

D600(1200)mm TYPE

- With space-saving design, this type can cope with limited space.

D700(1400)mm TYPE

- This type can ensure enough space for general office design.

Double-sided Basic Platform

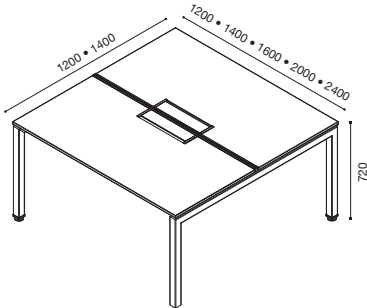

D1200mm		D1400mm	
Wmm	Cat. No.	Wmm	Cat. No.
1200	5-177-1011	1200	5-177-1111
1400	5-177-1021	1400	5-177-1121
1600	5-177-1031	1600	5-177-1131
2000	5-177-1051	2000	5-177-1151
2400	5-177-1061	2400	5-177-1161

Single-sided Basic Platform

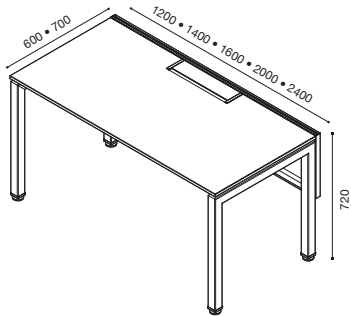

D600mm		D700mm	
Wmm	Cat. No.	Wmm	Cat. No.
1200	5-177-1511	1200	5-177-1611
1400	5-177-1521	1400	5-177-1621
1600	5-177-1531	1600	5-177-1631
2000	5-177-1551	2000	5-177-1651
2400	5-177-1561	2400	5-177-1661

Main Body Specification

Table Top : Low Presser melamine, particle board  
Thickness of Table Top : 18mm  
Table leg: Steel, white Paint

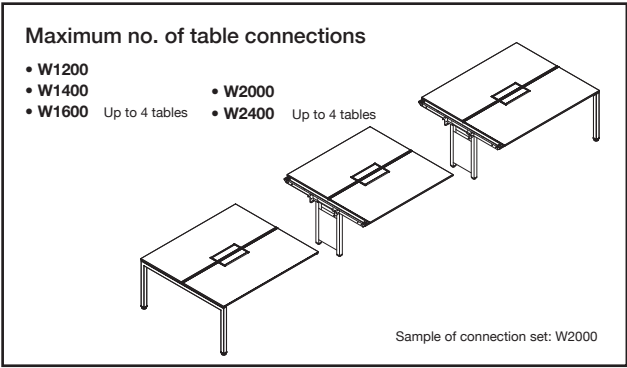

Double-sided Connection Platform

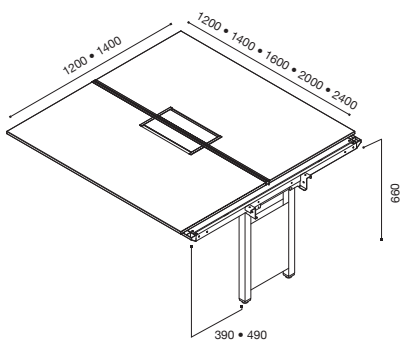

D1200mm		D1400mm	
Wmm	Cat. No.	Wmm	Cat. No.
1200	5-177-1211	1200	5-177-1311
1400	5-177-1221	1400	5-177-1321
1600	5-177-1231	1600	5-177-1331
2000	5-177-1251	2000	5-177-1351
2400	5-177-1261	2400	5-177-1361

Single -sided Connection Platform

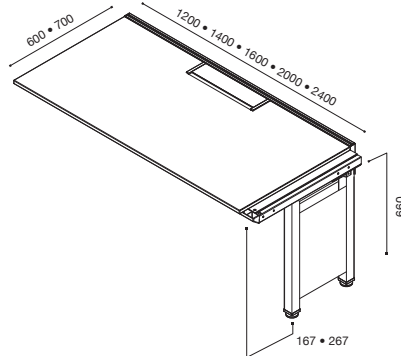

D600mm		D700mm	
Wmm	Cat. No.	Wmm	Cat. No.
1200	5-177-1711	1200	5-177-1811
1400	5-177-1721	1400	5-177-1821
1600	5-177-1731	1600	5-177-1831
2000	5-177-1751	2000	5-177-1851
2400	5-177-1761	2400	5-177-1861

Color of Table Top :

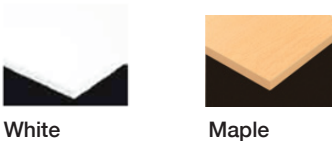

DESKTOP PANEL

Front Desktop Panel

H350mm ( Fabric )
Wmm
1200
1400
1600
2000
2400

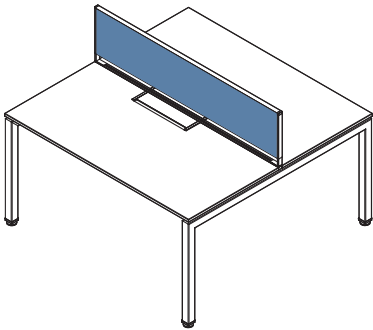

H450mm ( Fabric )
Wmm
1200
1400
1600
2000
2400

Side Desktop Panel (End/Middle)

H350mm ( Fabric )
Wmm
600
700
800

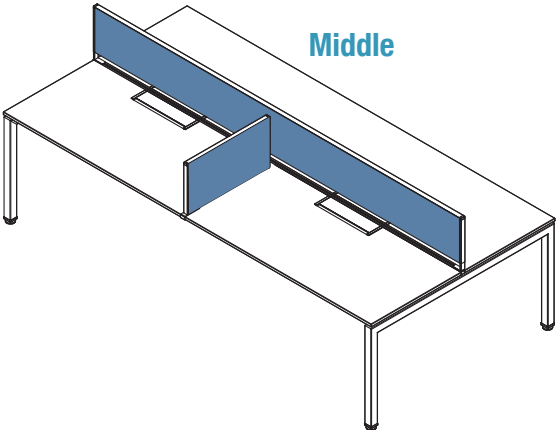
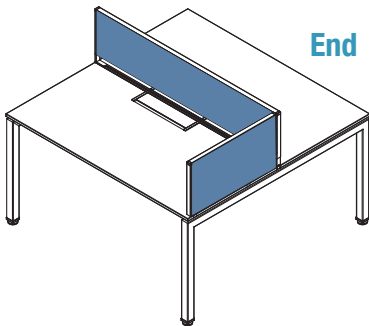

H450mm ( Fabric )
Wmm
600
700
800

□ : Panel fabric color no.  
\* For the details (price & cat. no.), please refer to the price list.

Panel Fabric Colors

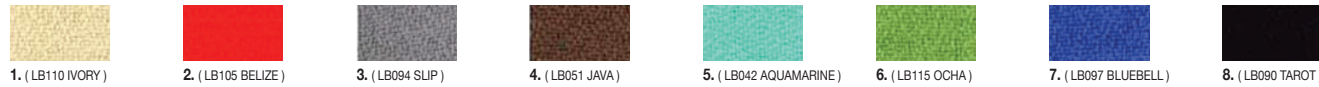

OPTION



SIDE MODESTY PANEL

Wmm	Cat. No.
600	5-177-6600
700	5-177-6610
1200	5-177-6620
1400	5-177-6630

1 pcs with 1 unit





**UCHIDA**

## **UCHIDA YOKO GLOBAL LIMITED**

### **Hong Kong Headquarter**

Unit 3, 9/F, AXA Centre, 151 Gloucester Road,  
Wan Chai, Hong Kong  
Tel: +852-2877-3663 Fax: +852-2877-3132

### **Tokyo Branch**

Uchida Yoko, 6/F, 4-7, Shinkawa 2-Chome,  
Chuo-ku, Tokyo 104-8282 Japan  
Tel: +81-3-3555-4781 Fax: +81-3-3555-6423/6424  
Email: sales@uchidayoko.com  
<http://www.uchidayoko.com> <http://www.uchida.co.jp>